

SETUP INSTRUCTION



ZHEJIANG CFMOTO POWER CO., LTD.
No. 116, Wuzhou Road,
Yuhang Economic Development Zone,
Hangzhou City, Zhejiang, 311100

T: +86-571-89265799
F: +86-571-89265788
export@cfmoto.com.cn
www.cfmoto.com

REAR WINDSHIELD



EXPERIENCE
MORE
TOGETHER

S/N: 5HY#-805210-1200-10

FOREWORD:

All setup work must be performed before the vehicle is delivered to the customer.

Read and understand the instructions before starting any setup work.

This setup instruction was written to correspond to the latest state of the model series. Please contact CFMOTO Technical Support for assistance if differences are found.

It is assumed that the work will be performed by a fully trained mechanic.

Zhejiang CFMOTO Power Co., Ltd.

All rights reserved.

Reproduction, even in part, as well as copying of all kinds, is permitted only with the express written permission of the copyright owner.

MEANING OF SYMBOLS



- Indicates information with more details or tips.



- Indicates information of warning or danger.

ACCESSORY LIST:



S/N	PART NAME	PART NUMBER	QTY.	REMARK
1	BOLT M6x20	30006-060020870	4	
2	NUT M8-13	5HY#-805103-1200	4	
3	FIXING PLATE, UPPER	5HY#-805230-1200	4	
4	WINDSHIELD	5HY#-805210-1200-10	1	
5	GASKET	5HY#-805101-1200	8	
6	SCREW M8x20	30102-080020870	8	
7	CUSHION	5HY#-805204-1200	4	
8	RUBBER PAD	5HY#-805102-1200	4	
9	FIXING PLATE, LOWER	5HY#-805250-1200	4	

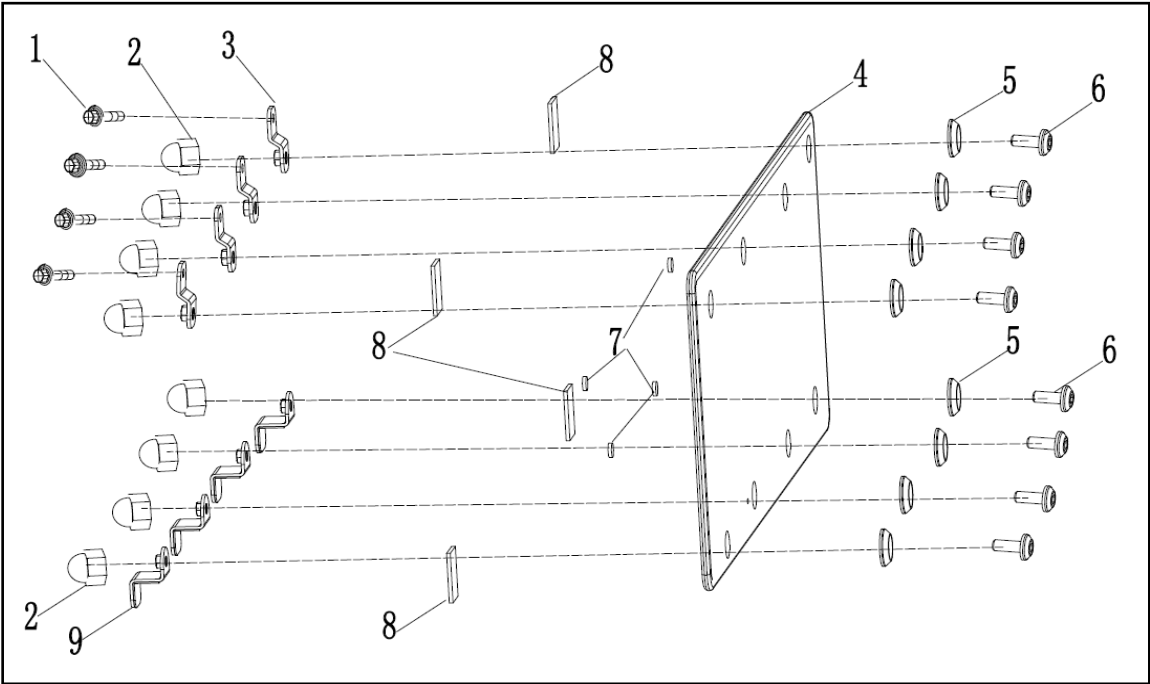

Accessory items supplied may be different based on market regulations / orders.

PREPARATION:

CRATE INSPECTION

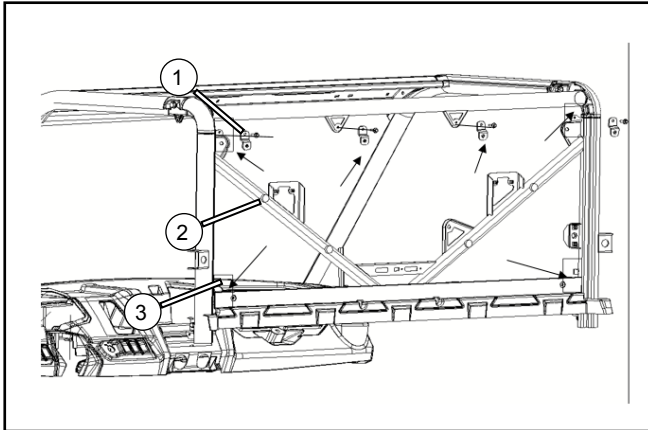

- // Install the upper fixing plates (1) as the left illustration, install and pre-lock screws, and then stick on the cushions (2), and stick the rubber pads (3) on four corners.

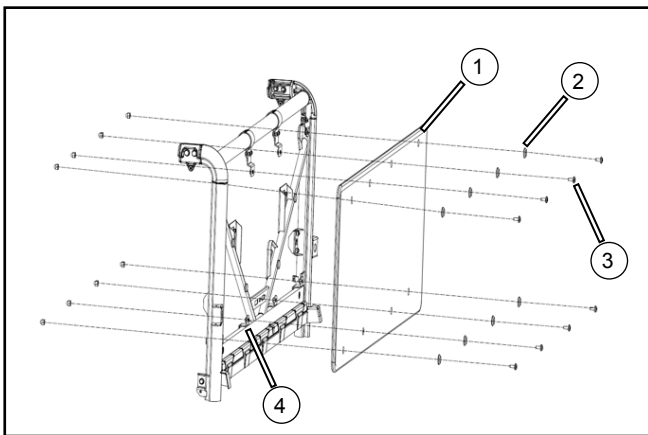

- // Put the windshield (1) in the assembly position.
- // Install gaskets (2) and screws (3) M8x20, and pre-lock screws. Install the lower fixing plates (4) in the inner side.
- // Install gaskets and screws M8x20.
- // Check and adjust the left and right clearance.

EXPERIENCE MORE TOGETHER

